

Fire Rated Door Range

With Certifire certifications of up to FD120 2 hours fire protection, our Fire Rated Doors are an excellent choice for meeting fire safety and insurance requirements.

Affordable fire protection for any property

Our Steel Fire Rated Doors offer a maximum of 2 hours of fire safety as they are certified up to FD120, making them suitable for FD30 and FD60 purposes as well. In accordance with fire protection regulations, these doors come with a door closer pre-installed.

These doors include our industry-leading HOOPLY™ multi point locking systems with 19 locking points, mineral wool insulation, internal reinforced bars, and 4 UKCA/CE marked stainless steel ball bearing hinges.



VIEW THE FULL RANGE



Flush



Cottage



Panelled

CERTIFICATION	FD120 - up to 2 hours fire protection (Available as a Dual Certified PAS 24 Fire Rated Version)		
DOOR SIZE (MM)	695-1195x2020 & 910x2065	695-1195x2020	845-995x2020
DOOR DEPTH	50mm Thickness		
MATERIAL & GAUGE	1.0mm Galvanised Steel		
INT. REINFORCING	3 x Reinforced Bars		
DOOR & FRAME SEAL	FRAME - Nylon Self Adhesive V-seal DOOR - Flat Compression Self Adhesive Seal		
FRAME DEPTH	90mm Depth		
MATERIAL & GAUGE	1.8mm Galvanised Steel		
HINGES	4 x UKCA & CE S/Steel Ball Bearing Hinges		
ACOUSTIC RATING	35dB		

What is a fire rated certification ?

Fire Rated Certification

Fire Rated Certification is a standard set by Certifire, who is an independent third-party certification scheme that assures performance, quality, reliability and traceability of products and systems.

Architects, specifiers, contractors, and building owners can all benefit from fire rated doors since it guarantees that properly installed fire prevention will function as expected. As a result, costly mistakes are avoided, and risk is drastically reduced.



Fire doors are assigned an FD rating associated with length of time they can withstand fire for. For instance an FD30 fire door will offer 30 minutes of protection, while an FD60 fire door will offer 60 minute fire protection.

The FD rating is assigned following stress testing in conditions specified in British Standards 476 part 22:1987.

The most common integrity ratings are:

- ✓ FD30 – 30 minutes
- ✓ FD60 – 60 minutes
- ✓ FD90 – 90 minutes
- ✓ FD120 – 120 minutes

Additional options available

Our personalisation options on fire rated doors include a pre-fitted door closer fitted to the pull or push side and the option to powder coat the door to suit a property from stock Latham’s White to a range of colours.

RAL & BS Colour Examples

RAL 1021 Colza Yellow	BS 08 B29 Canary Yellow	RAL 2003 Pure Orange	RAL 3020 Traffic Red
RAL 5002 Ultramarine Blue	RAL 5013 Cobalt Blue	RAL 5015 Sky Blue	RAL 5017 Traffic Blue
BS 12 B21 Juniper Green	RAL 6002 Leaf Green	RAL 6005 Moss Green	RAL 6009 Fir Green
BS 08 B29 Van Dyke Brown	BS 18 B25 Merlin Grey	RAL 7102 Basalt Grey	RAL 7015 Slate Grey
RAL 7016 Anthracite Grey	RAL 7040 Window Grey	RAL 9005 Jet Black	RAL 9006 White Aluminium

Our fire rated door range all come with a 3* Kitemark Cylinder as standard, this includes enhanced security features along with:

- ✓ BSi 3* Kitemarked – KM561977
- ✓ Sold Secure Diamond Standard
- ✓ Secured by Design approved
- ✓ 6 pins
- ✓ Sacrificial cut line on the external cylinder side
- ✓ Patented anti-bump feature
- ✓ 4 hardened steel anti-drill pins per side
- ✓ Tested to EN1303:2005

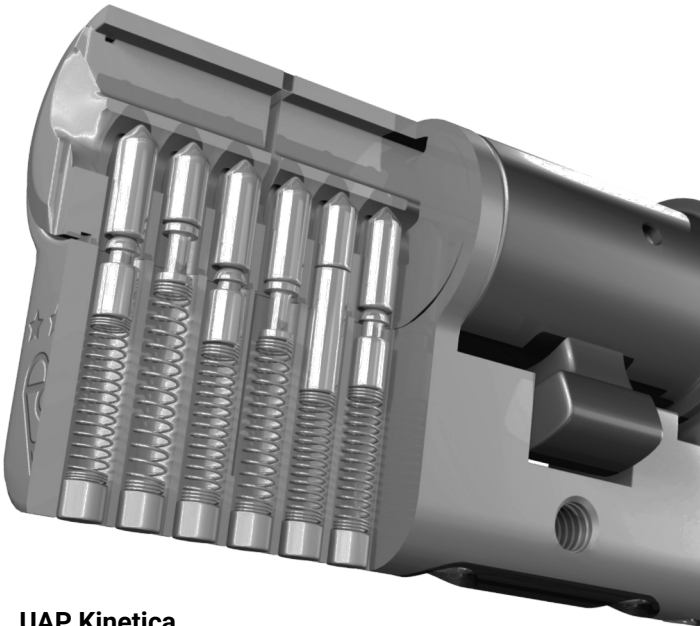

UAP Kinetica
3* Kitemarked Cylinder



LATHAM'S[®]

STEEL SECURITY DOORSETS



35/37 Hainge Road, Tividale, Oldbury,
West Midlands, B69 2NY



01384 220050



sales@lathamssteeldoors.co.uk



www.lathamssteeldoors.co.uk

